

THIS DRAWING IS COPYRIGHT AND REMAINS THE PROPERTY OF HT ARCHITECTS. IT MUST NOT BE REPRODUCED, COPIED, DISCLOSED OR TRANSMITTED TO THIRD PARTIES IN ANY FORM, IN WHOLE OR IN PART, WITHOUT PRIOR WRITTEN PERMISSION FROM HT ARCHITECTS.

ALL DIMENSIONS SHOULD BE CHECKED ON SITE BEFORE WORK COMMENCES

SUBJECT TO LEVELS REVIEW

WIDEN ACCESS/EGRESS LANES AND RADII ON BOTH SIDES OF JUNCTION. TRAFFIC SIGNALS EQUIPMENT TO BE MOVED TO MATCH THE NEW JUNCTION LAYOUT

REINSTATE EXISTING SERVICE ACCESS AS FOOTWAY

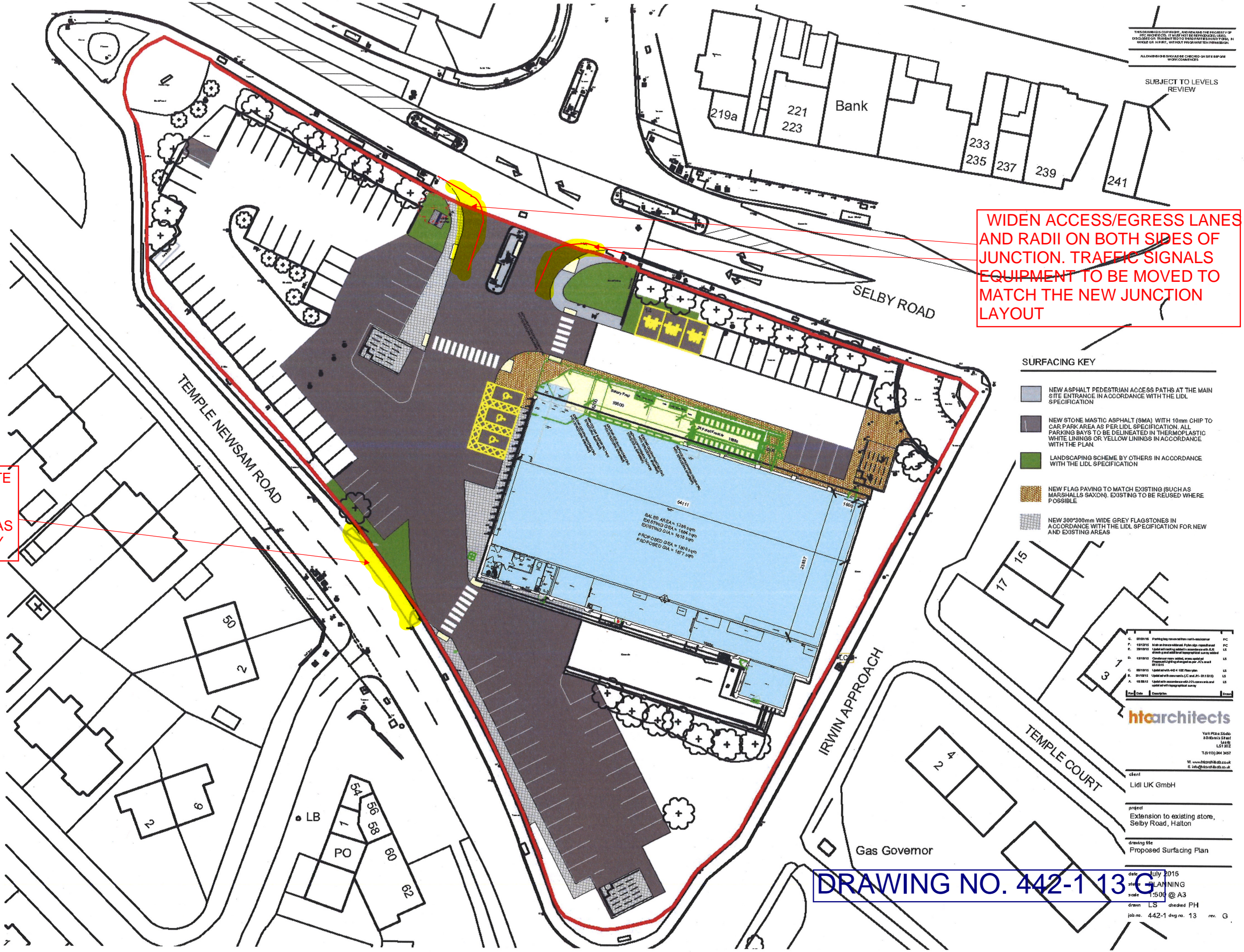

- SURFACING KEY**
- NEW ASPHALT PEDESTRIAN ACCESS PATHS AT THE MAIN SITE ENTRANCE IN ACCORDANCE WITH THE LIDL SPECIFICATION
 - NEW STONE MASTIC ASPHALT (SMA) WITH 10mm CHIP TO CAR PARK AREA AS PER LIDL SPECIFICATION. ALL PARKING BAYS TO BE DELINEATED IN THERMOPLASTIC WHITE LININGS OR YELLOW LININGS IN ACCORDANCE WITH THE PLAN
 - LANDSCAPING SCHEME BY OTHERS IN ACCORDANCE WITH THE LIDL SPECIFICATION
 - NEW FLAG PAVING TO MATCH EXISTING (SUCH AS MARSHALLS SAXON). EXISTING TO BE REUSED WHERE POSSIBLE
 - NEW 300*300mm WIDE GREY FLAGSTONES IN ACCORDANCE WITH THE LIDL SPECIFICATION FOR NEW AND EXISTING AREAS

Code	Description	Quantity
G	010115 Paving by re-use of existing materials	PC
F	151215 Multi-use access material, Poly-ster, resin bound	LS
E	201815 Asphalt road surfacing, 100mm thick, 10% stone dust and 10% bitumen	LS
D	151815 Concrete paving, 100mm thick, resin bound	LS
C	010115 Paving by re-use of existing materials	LS
B	201815 Asphalt road surfacing, 100mm thick, 10% stone dust and 10% bitumen	LS
A	151815 Concrete paving, 100mm thick, resin bound	LS

htarchitects
York Place 5646
55-57 Selby Street
LS1 2JZ
T: 0113 264 3457
W: www.htarchitects.co.uk
E: info@htarchitects.co.uk

client
Lidl UK GmbH

project
Extension to existing store,
Selby Road, Halton

drawing title
Proposed Surfacing Plan

date July 2015
stage PLANNING
scale 1:500 @ A3
drawn LS checked PH
job no. 442-1 dwg no. 13 rev. G

DRAWING NO. 442-1 13 G